

Note: The vacuum cleaner comes preassembled, with the accessory adaptor attached to the air inlet.

The accessory adaptor can be removed by pressing the accessory adaptor button while pulling it away from the air inlet.

Warning: Do not use the vacuum cleaner without the HEPA filter, dust container or cyclonic cone in position.

Do not use the vacuum cleaner if the dust container is filled past the max. fill mark, as this could damage the vacuum cleaner or cause injury to the user.

Using the Telescopic Extension Tube

The floor brush, crevice tool and brush tool fit onto the telescopic extension tube to allow for a more accessible, convenient clean.

STEP 1: Fit the telescopic extension tube onto the accessory adaptor.

STEP 2: Push the chosen attachment onto the end of telescopic extension tube and secure into place.

STEP 3: Adjust the telescopic extension tube to the required length by pressing the telescopic extension tube button down and sliding the inner tube in or out.

Using the Floor Brush

STEP 1: Fit the telescopic extension tube onto the accessory adaptor.

STEP 2: Adjust the telescopic extension tube to the required length by pressing the telescopic extension tube button down and sliding the inner tube in or out.

STEP 3: Push the floor brush onto the end of the telescopic extension tube and secure into place.

Note: Lower the switch on the floor brush to expose the bristles for use on hard floors. Lift the switch to hide the bristles for use on carpets.

Cleaning the Dust Container and HEPA Filter

For full cleaning instructions, please see the online instruction manual.

Note: The dust container must be removed from the handheld unit before emptying.

Warning: The dust container and filter need to be emptied and cleaned regularly to preserve suction, prevent overheating and prolong the life of the vacuum cleaner.

Storage

Check that the vacuum cleaner is cool, clean and dry before storing in a cool, dry place.

Specifications

Product code: BEL0769

Rated voltage: 220-240 V ~ 50-60 Hz

Rated wattage: 600 W

EN

If this product does not reach you in an acceptable condition please contact our Customer Services Department at www.beldray.com. Please have your delivery note to hand as details from it will be required. If you wish to return this product, please return it to the retailer from where it was purchased with your receipt (subject to their terms and conditions). Go to www.beldray.com and search **BEL0769N** to access the instruction manual for your product.

*To be eligible for the extended guarantee, go to www.beldray.com and register your product within 30 days of purchase.

The crossed out wheellie bin symbol on this item indicates that this appliance needs to be disposed of in an environmentally friendly way when it becomes of no further use or has worn out. Contact your local authority for details of where to take the item for recycling.



Beldray[®] est. 1872

QUICK VAC LITE

TWO IN ONE

QUICK START GUIDE

Find us on **f**

www.facebook.com/Beldray

Manufactured by:

UP Global Sourcing UK Ltd.,
Victoria Street, Manchester OL9 0DD. UK.

MADE IN CHINA.

www.beldray.com

CD170320/MD000000/V1

Safety Instructions

When using electrical appliances, basic safety precautions should always be followed.

Check that the voltage indicated on the rating plate corresponds with that of the local network before connecting the appliance to the mains power supply.

Children aged from 8 years and people with reduced physical, sensory or mental capabilities or lack of experience and knowledge can use this appliance, only if they have been given supervision or instruction concerning use of the appliance in a safe way and understand the hazards involved.

Children should be supervised to ensure that they do not play with the appliance.

Unless they are older than 8 and supervised, children should not perform cleaning or user maintenance.

This appliance contains no user serviceable parts. If the power supply cord, plug or any part of the appliance is malfunctioning or if it has been dropped or damaged, do not use. Only a qualified electrician should carry out repairs. Improper repairs may place the user at risk of harm.

Do not remove from the mains power supply by pulling the cord; switch off and remove the plug by hand.

Do not pull or carry the appliance by its power supply cord.

Do not use this appliance if any of the openings are blocked.

Take care when equipping accessories with rotating parts as this could cause entrapment. Switch off the appliance, disconnect it from

the mains power supply and allow to cool fully before changing or fitting accessories and before cleaning or user maintenance. Use of an extension cord with the appliance is not recommended.

This appliance should not be operated by means of an external timer or separate remote control system.

This appliance is intended for domestic use only. It should not be used for commercial purposes.

Thermal Cut-out Device

If the dust container and HEPA filter are not cleaned on a regular basis, the vacuum cleaner may overheat. This will cause the thermal cut-out device to activate due to restricted flow of air around the appliance. If the vacuum cleaner cuts out, press the power switch to turn it off and unplug it from the mains power supply. Proceed to empty the dust container, clean the HEPA filter and allow the vacuum cleaner to cool for approx. 1 hour.

Description of Parts

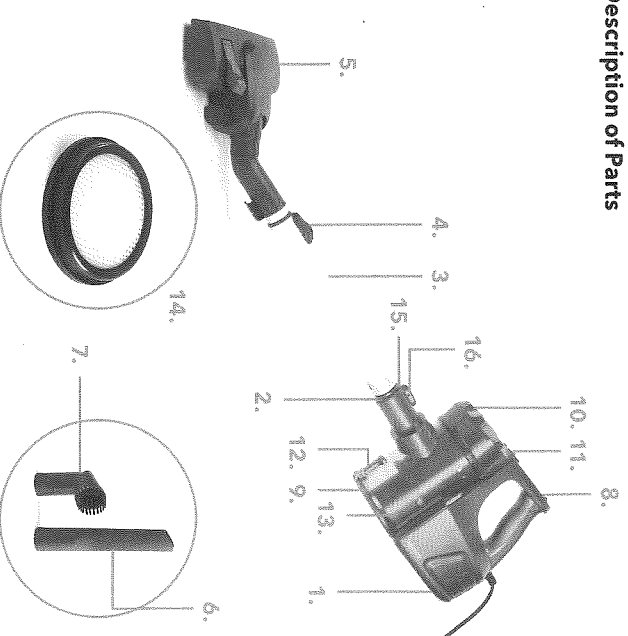

1. Quick Vac Lite Two in One handheld unit
2. Air inlet
3. Telescopic extension tube
4. Telescopic extension tube button
5. Floor brush
6. Crevice tool
7. Brush tool
8. Power switch
9. 600 ml removable dust container
10. Dust container lid
11. Dust container release button
12. Dust container base release latch
13. Cyclonic cone
14. HEPA filter
15. Accessory adaptor
16. Accessory adaptor button

Instructions for Use

Before First Use

Before using the vacuum cleaner for the first time, wipe it with a soft, damp cloth and dry thoroughly. Do not immerse the vacuum cleaner in water or any other liquid.

Using the Quick Vac Lite Two in One

STEP 1: Plug in and switch on the vacuum cleaner at the mains power supply.

STEP 2: Turn on the vacuum cleaner by pressing the power switch to the on position. To turn it off, press the power switch to the off position.